

For
Lease



Move-In Ready Professional Office Space

IN THE NORTHEAST HEIGHTS MINUTES FROM UPTOWN



**±1,349 RSF
Available**

2727 San Pedro Dr. NE | Albuquerque, NM 87110

Lauren Landavazo

lauren@sunvista.com | 505 227 0585

Shelly Branscom CCIM

shelly@sunvista.com | 505 414 2669

NAI SunVista] **Got Space™**

Opening the Door to Commercial Real Estate Excellence

For Lease

2727 San Pedro Dr. NE | Albuquerque, NM 87110



PROPERTY

AVAILABLE

Suite 117: ±1,349 RSF

LEASE RATE

\$15.50/RSF Full Service
(Less In-Suite Janitorial)

HIGHLIGHTS

- Walking distance to Quigley Park
- Within minutes of Uptown amenities
- Easy access to I-40
- Renovated common areas and suites
- Open-office architecture
- Solar tubes for enhanced natural light
- Building enjoys long-term tenancy
- 4.1:1,000 parking ratio
- Monument signage available

ZONING [MX-M](#) 

LOCATION

NWQ Menaul Blvd. &
San Pedro Dr. NE

For Lease

2727 San Pedro Dr. NE | Albuquerque, NM 87110



LOCATION

Demographics	1 Mile	3 Mile	5 Mile
Total Population	13,461	123,417	314,870
Average HH Income	\$80,310	\$81,821	\$86,749
Daytime Employment	17,775	100,672	259,721

2024 Forecasted by Esri



For Lease

2727 San Pedro Dr. NE | Albuquerque, NM 87110



Common Area Lobby



Quigley Park Across the Street

Monument Signage



NAI SunVista

505 878 0001 | sunvista.com
2424 Louisiana Blvd. NE | Suite 100
Albuquerque, NM 87110

Lauren Landavazo
lauren@sunvista.com
505 227 0585

Shelly Branscom CCIM
shelly@sunvista.com
505 414 2669

For Lease

2727 San Pedro Dr. NE | Albuquerque, NM 87110

SUITE 117



NAI SunVista

505 878 0001 | sunvista.com
2424 Louisiana Blvd. NE | Suite 100
Albuquerque, NM 87110

Lauren Landavazo
lauren@sunvista.com
505 227 0585

Shelly Branscom CCIM
shelly@sunvista.com
505 414 2669

For Lease

2727 San Pedro Dr. NE | Albuquerque, NM 87110

FLOOR PLAN

San Pedro Dr. NE

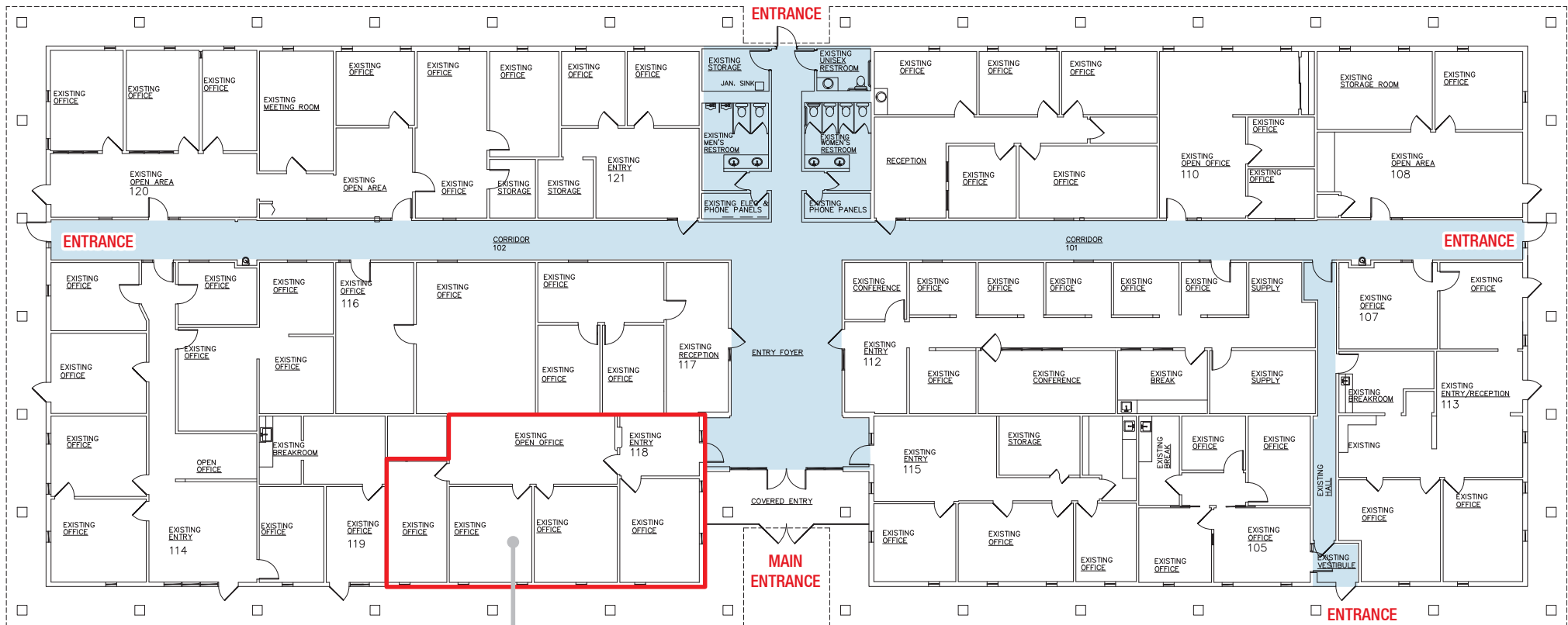

Available

Common Area

AVAILABLE
Suite 117
±1,349 RSF

PARKING

