

For Sale

Improved Industrial Land

IN THE GROWING WESTPOINTE 40 INDUSTRIAL PARK



WITH BUILDING PLANS

±6.43 Acres Available

9250 Daytona Rd. NW | Albuquerque, NM 87121

NAI SunVista **Got Space™**

Opening the Door to Commercial Real Estate Excellence

Alex Pulliam

alex@sunvista.com | 505 350 5729

Riley McKee CCIM, SIOR

riley@sunvista.com | 505 379 1549

For Sale

9250 Daytona Rd. NW | Albuquerque, NM 87121

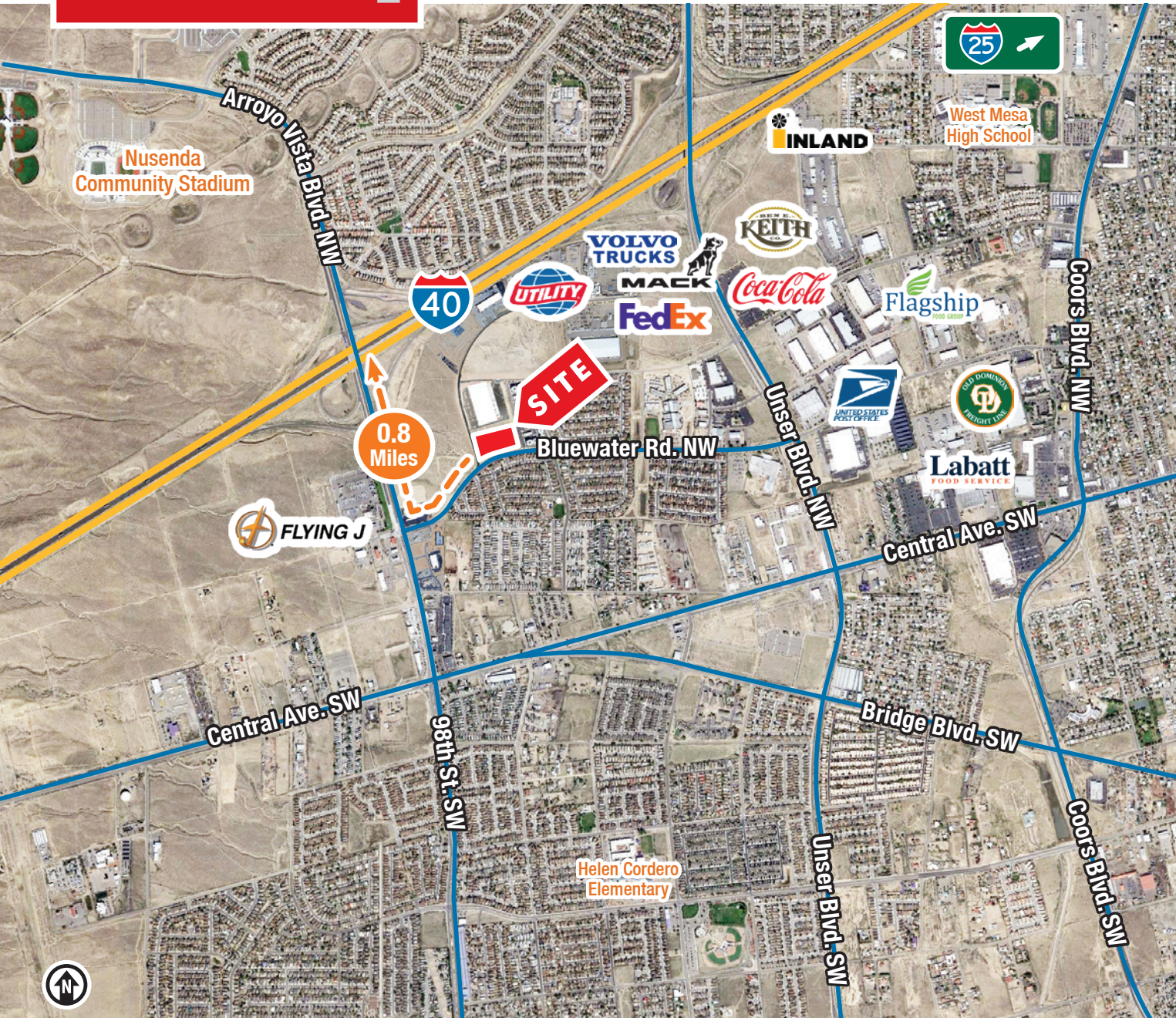

PROPERTY

AVAILABLE

Land: ±6.43 Acres

SALE PRICE

\$2,450,800

ZONING

- NR-BP
- Permitted uses include light manufacturing, warehousing and distribution

HIGHLIGHTS

- 98% building plans available for a ±79,800 SF distribution warehouse
- Less than 1 mile from I-40
- Off-site improvements underway
- Nearby utilities in Daytona Rd.
- Fully zoned and entitled for industrial uses
- Will be delivered with a detention pond in rough-graded condition with utilities and adjacent road infrastructure

LOCATION

- SWQ I-40 & 98th St. NW



MORE INFO



MORE INFO

NAISunVista

505 878 0001 | sunvista.com
2424 Louisiana Blvd. NE | Suite 100
Albuquerque, NM 87110

Alex Pulliam
alex@sunvista.com
505 350 5729

Riley McKee CCIM, SIOR
riley@sunvista.com
505 379 1549

For Sale

9250 Daytona Rd. NW | Albuquerque, NM 87121

SITE PLAN

AVAILABLE

±6.43 Acres

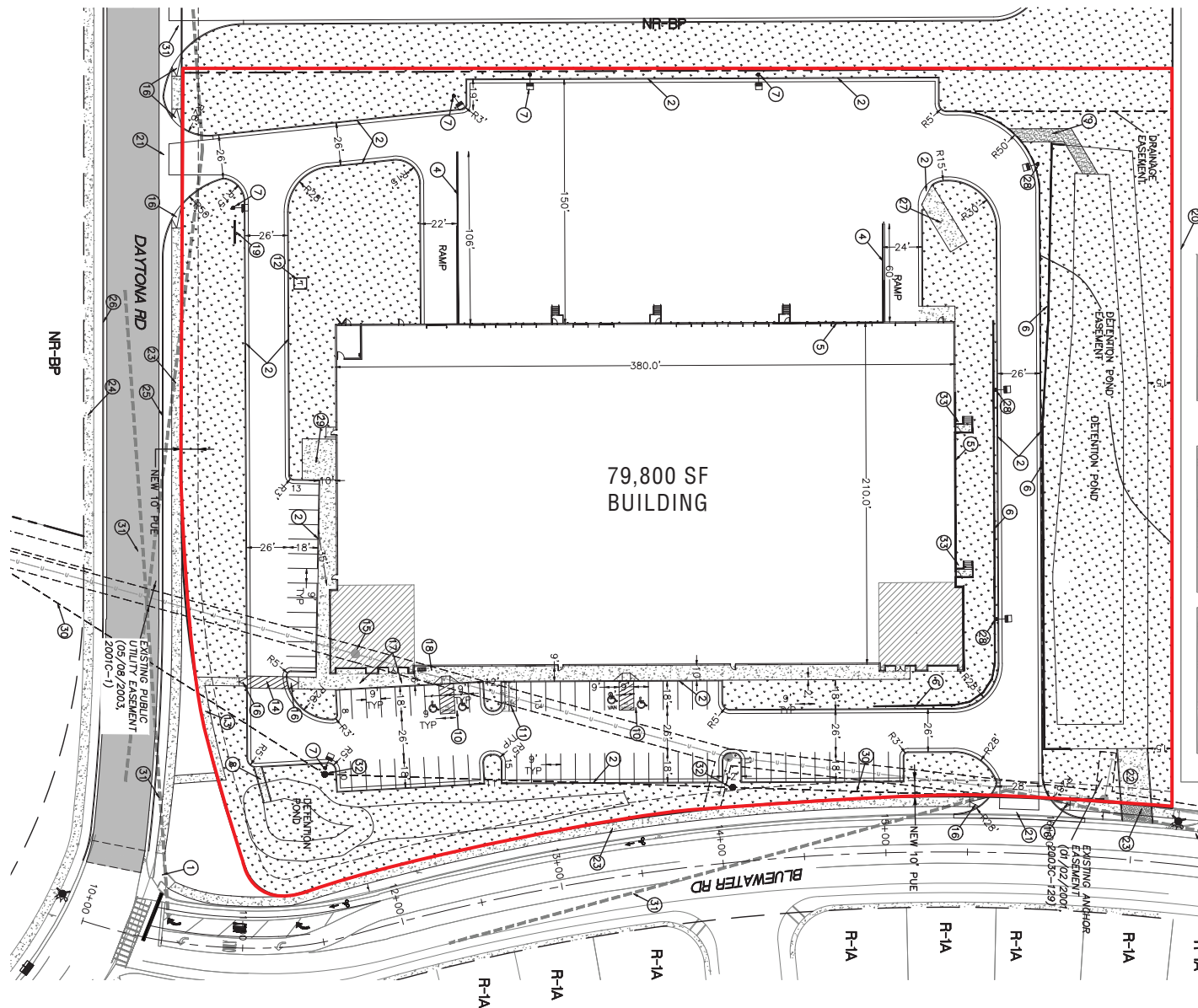

For Sale

9250 Daytona Rd. NW | Albuquerque, NM 87121



DRIVE TIMES

DESTINATION	MILES	DRIVE TIME
AMARILLO	289	4 hrs 10 min
CHEYENNE, WY	549	7 hrs 51 min
CHIHUAHUA, MX	503	8 hrs 12 min
CO. SPRINGS	379	5 hrs 21 min
DALLAS	650	9 hrs 30 min
DENVER	449	6 hrs 30 min
EL PASO	266	3 hrs 49 min
HOUSTON	841	12 hrs 50 min
LAS VEGAS	575	8 hrs 0 min
LOS ANGELES	787	11 hrs 37 min
LUBBOCK	322	5 hrs 5 min
OKLAHOMA CITY	544	7 hrs 48 min
PHOENIX	419	6 hrs 32 min
SALT LAKE CITY	599	9 hrs 46 min
SAN ANTONIO	709	10 hrs 52 min
SANTA FE	64	1 hr 3 min
TUCSON	449	6 hrs 27 min

Albuquerque

TRADE AREA ANALYSIS

A REGIONAL INDUSTRIAL HUB

Located near the geographic center of New Mexico at the intersection of I-25 and I-40, Albuquerque is the state's most populous city and one of the most livable in the U.S. The city serves as a major transportation and shipping hub for the Southwestern United States with the BNSF Railway, air cargo from Albuquerque International Airport (Sunport), and a commuter train running from Belen to Santa Fe. A talented workforce, a business-friendly environment, a community rooted in history and a high quality of life make Albuquerque hard to beat.

ALBUQUERQUE BY THE NUMBERS (ESRI 2025 Demographics)

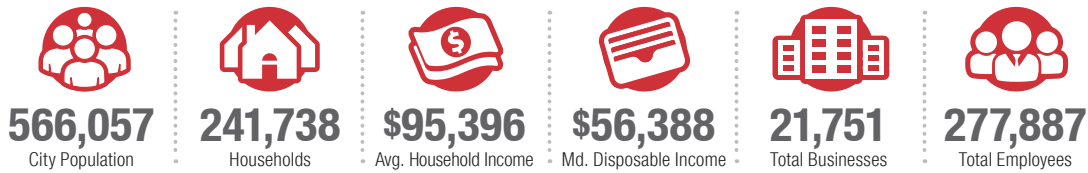

932,477
Albuquerque Metro
Population



**The
Largest**
City in the State



The West I-40 corridor is home to many of the region's largest distributors. It's ability to serve all New Mexico markets and beyond make this trade area one of the elite locations for large industrial users.



THE ALBUQUERQUE ADVANTAGE

- Low-risk location
- Skilled workforce
- Business incentives
- Quality of life
- Low cost of living
- On the cutting edge of technology



COMPETITIVE BUSINESS CLIMATE

Low energy costs, low property taxes, affordable real estate and cost of living, a qualified/productive workforce, aggressive incentives, efficient market access

