

For Lease

Princess Jeanne Shopping Center

IN A HIGH-TRAFFIC RETAIL CORRIDOR



42,200 CARS PER DAY

**±2,529 SF
Available**

1400 Eubank Blvd. NE | Albuquerque, NM 87112

Alexis Lovato

alexis@sunvista.com | 505 639 6433

John Algermissen CCIM

johna@sunvista.com | 505 998 5734

NAI SunVista] **Got Space™**

Opening the Door to Commercial Real Estate Excellence

For Lease

1400 Eubank Blvd. NE | Albuquerque, NM 87112



AVAILABLE

Suite 1410: ±2,529 SF

LEASE RATE

\$14.00/SF + NNN

- Full access off Eubank Blvd. and ample parking
- Quick access to I-40
- Prominent pylon signage
- Tenant improvement allowance available
- On-site security

LOCATION

NEC Eubank Blvd. & Constitution Ave. NE

ZONING MX-L

For Lease

1400 Eubank Blvd. NE | Albuquerque, NM 87112



LOCATION

Demographics	1 Mile	3 Mile	5 Mile
Total Population	15,984	147,691	270,541
Average HH Income	\$77,025	\$84,423	\$94,696
Daytime Employment	4,571	67,421	124,210

2025 Forecasted by Esri

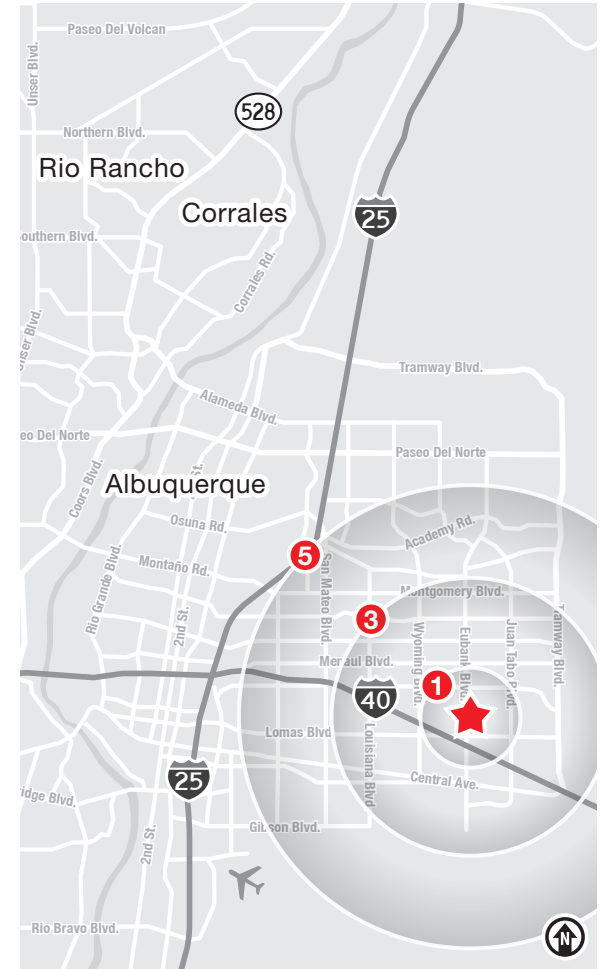

NAISunVista

505 878 0001 | sunvista.com
 2424 Louisiana Blvd. NE | Suite 100
 Albuquerque, NM 87110

Alexis Lovato
alexis@sunvista.com
 505 639 6433

John Algermissen CCIM
johna@sunvista.com
 505 998 5734

For Lease

1400 Eubank Blvd. NE | Albuquerque, NM 87112



NAI SunVista

505 878 0001 | sunvista.com
2424 Louisiana Blvd. NE | Suite 100
Albuquerque, NM 87110

Alexis Lovato
alexis@sunvista.com
505 639 6433

John Algermissen CCIM
johna@sunvista.com
505 998 5734

For Lease

1400 Eubank Blvd. NE | Albuquerque, NM 87112

SITE PLAN

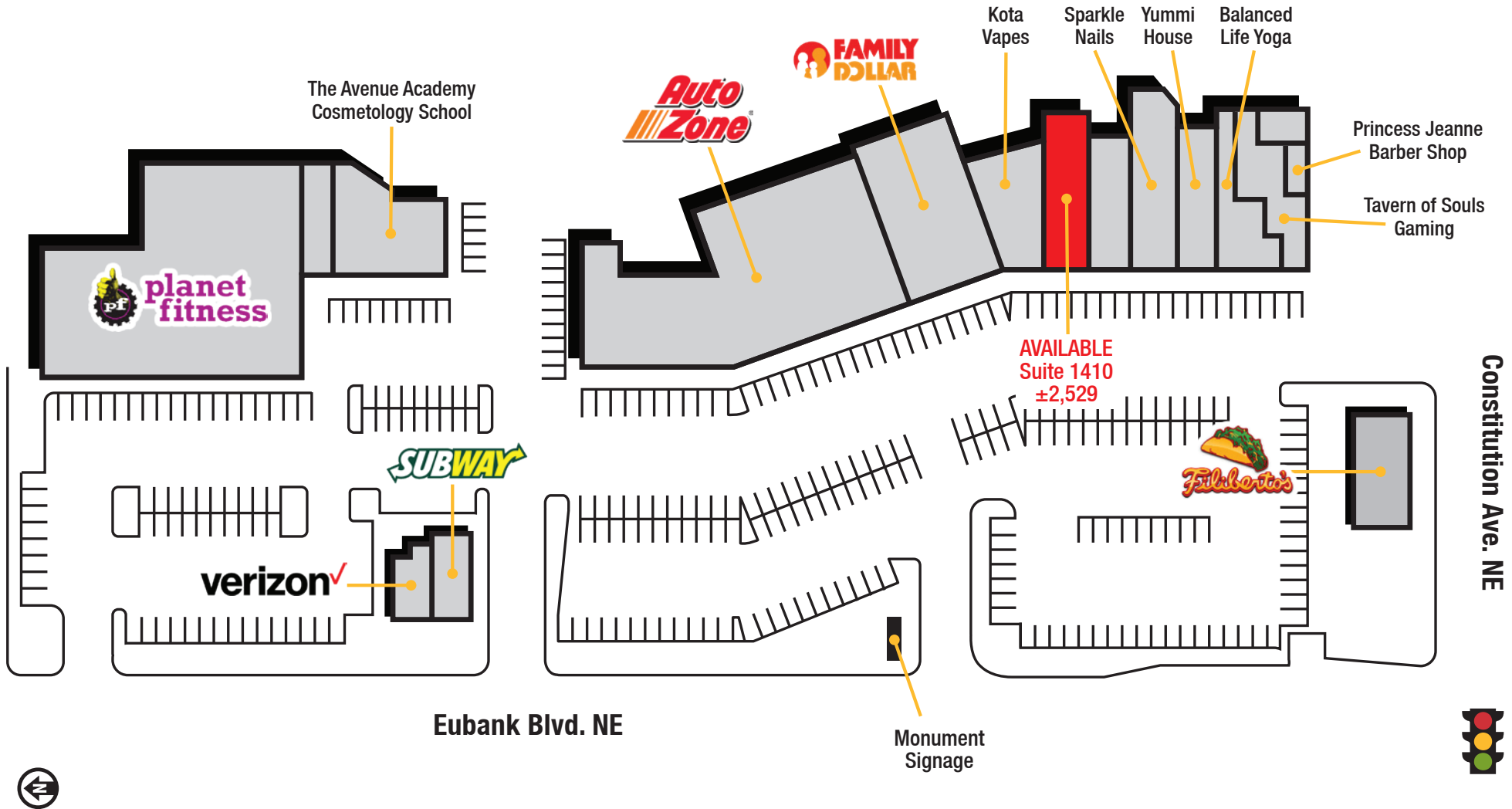

For Lease

1400 Eubank Blvd. NE | Albuquerque, NM 87112

FLOOR PLAN

SUITE 1410

±2,529 SF

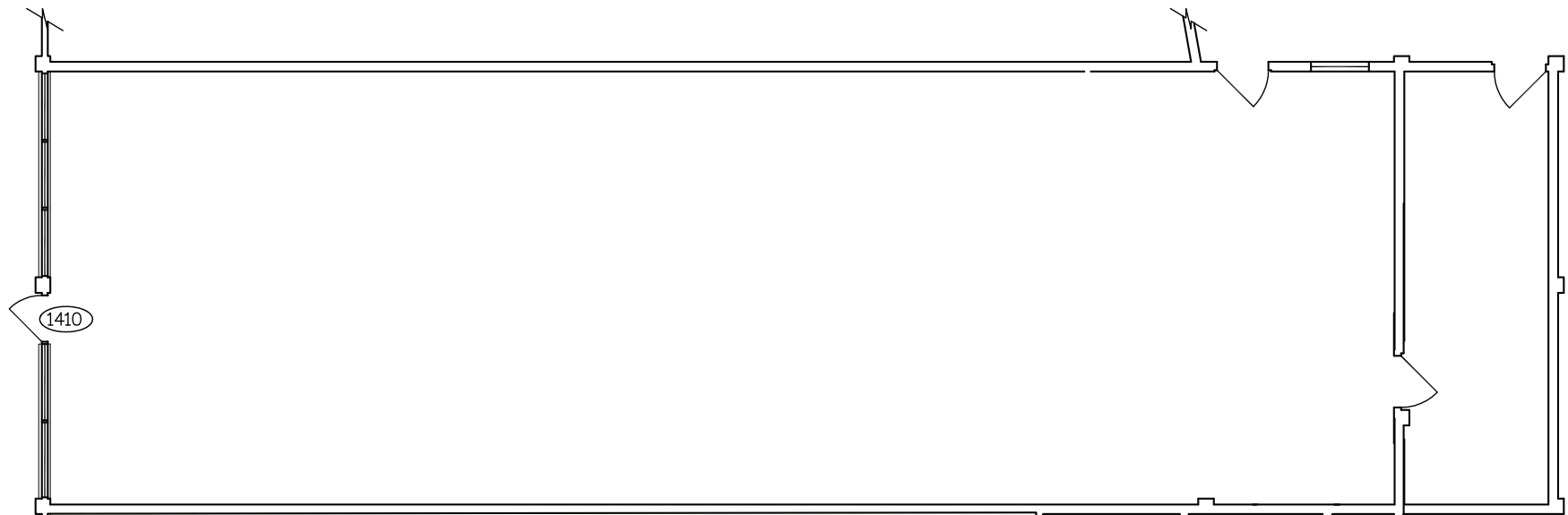

Albuquerque

TRADE AREA ANALYSIS

ALBUQUERQUE | NEW MEXICO

Located near the geographic center of New Mexico at the intersection of I-25 and I-40 and resting at the foot of the Sandia Mountains, Albuquerque is the state's most populous city and one of the most livable in the U.S. The city serves as a major transportation and shipping hub for the Southwest, with BNSF Railway, air cargo from Albuquerque International Airport (Sunport), and a commuter train running from Belen to Santa Fe. Albuquerque is home to the International Balloon Fiesta, the world's largest gathering of hot-air balloons. A talented workforce, a business-friendly environment, a community rooted in history and a high quality of life make Albuquerque hard to beat.

ALBUQUERQUE BY THE NUMBERS (ESRI 2025 Demographics)

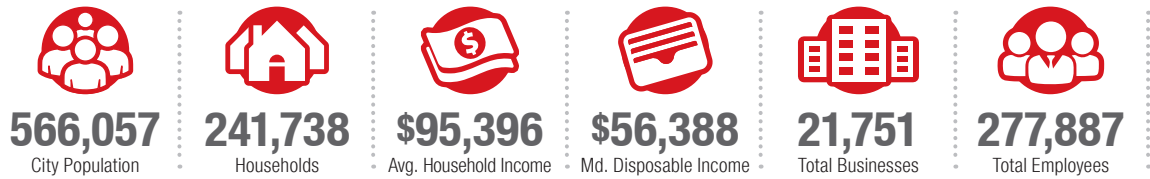

932,477
Albuquerque Metro Population



The Largest
City in the State

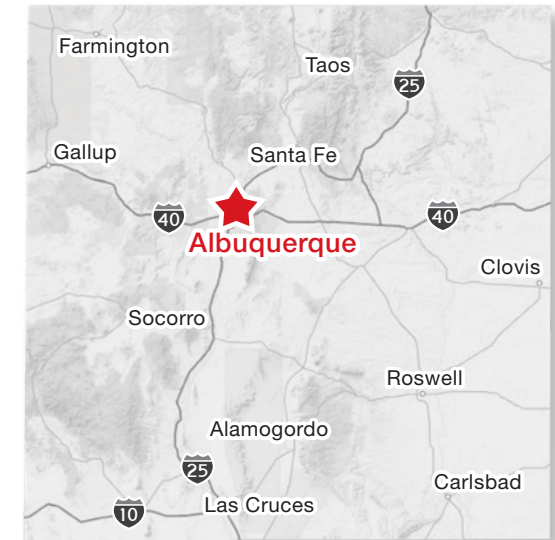

In the News

Ranked 6th in America's favorite cities list - *Travel + Leisure*
Ranks among America's best cities for global trade - *Global Trade Magazine*
The 5th most cost-friendly city to do business in the U.S. - *KPMG*

TOP 8 REASONS TO CHOOSE ALBUQUERQUE

- Low-risk location
- Skilled workforce
- Business incentives
- The metro area communities
- Quality of life
- Cost of living
- Innovation central
- On the cutting edge of technology



HEALTHCARE

Albuquerque is the center of health care excellence in New Mexico. UNM is a nationally-recognized Class 1 research institution. There are more than 2,000 hospital beds in the metro area.



EDUCATION | SKILLED WORKFORCE

Albuquerque is top in nation for cities with the most college graduates – more than 70,000 college students reside in metro area. The area also has one of the largest number of PhD's per capita in the nation.



COMPETITIVE BUSINESS CLIMATE

Low energy costs, low property taxes, affordable real estate, low cost of living, a qualified/productive workforce, aggressive incentives and efficient market access make Albuquerque an attractive choice.